



# Smith & Wesson®

## Safety & Instruction Manual

## SW22 VICTORY® Pistol



SW22 VICTORY®



**This Manual Covers:**

SW22 Victory®

SW22 Victory® Target

SW22 Victory® Performance Center®



**Read the instructions and warnings in this manual CAREFULLY BEFORE using this firearm.**

2100 Roosevelt Avenue • Springfield, MA 01104

1-800-331-0852 • Fax: 413-747-3317

[www.smith-wesson.com](http://www.smith-wesson.com)

Copyright © 2018 Smith & Wesson Corp.

All rights reserved.



**WARNING:  
READ THESE**



**INSTRUCTIONS AND WARNINGS  
CAREFULLY. BE SURE YOU UN-  
DERSTAND THESE INSTRUCTIONS  
AND WARNINGS BEFORE USING  
THIS FIREARM. FAILURE TO READ  
THESE INSTRUCTIONS AND TO  
FOLLOW THESE  
WARNINGS MAY RESULT  
IN SERIOUS INJURY OR DEATH  
TO YOU AND OTHERS AND  
DAMAGE TO PROPERTY.**

**This SAFETY & INSTRUCTION  
MANUAL should always  
accompany this firearm and be  
transferred with it upon change of  
ownership or when presented to  
another person. A copy of the  
SAFETY & INSTRUCTION  
MANUAL is available FREE  
via download at  
[www.smith-wesson.com](http://www.smith-wesson.com)  
or upon request from:**

**SMITH & WESSON®  
CUSTOMER SUPPORT CENTER  
2100 ROOSEVELT AVENUE  
SPRINGFIELD, MA 01104  
TEL.: 1-800-331-0852, ext. 4125  
E-mail: [qa@smith-wesson.com](mailto:qa@smith-wesson.com)**

## TABLE OF CONTENTS

YOUR SAFETY RESPONSIBILITIES .....	3-6
SAFE STORAGE AND TRANSPORTATION.....	7-8
AMMUNITION .....	8-10
MODEL AND FEATURES IDENTIFICATION .....	11
TRIGGER ADJUSTMENT SCREW(S) .....	11
INSPECTING YOUR PISTOL .....	12-13
PREPARATION FOR FIRING .....	13-14
LOADING .....	14-17
FIRING .....	17-18
CLEARING MISFIRES.....	18-19
UNLOADING .....	19
REAR SIGHT ADJUSTMENT.....	20
OPTICAL SIGHT MOUNT .....	20-22
FIELD STRIPPING / DISASSEMBLY .....	23-25
BARREL REMOVAL .....	26-27
LUBRICATION .....	27
FIELD STRIPPING / ASSEMBLY .....	28-29
MAGAZINE.....	29-30
CLEANING AND MAINTENANCE .....	31-33
LIMITED WARRANTY .....	33-34
CONTACT AND SHIPPING INFORMATION .....	35-36
CUSTOM SERVICE, PATENTS, INT'L WARRANTY CENTERS .....	37
PERFORMANCE CENTER® MODEL TRIGGER ADJUST .....	38-40
BATTERY WARNINGS.....	41
MUZZLE COMPENSATOR (If so-equipped).....	42

# YOUR SAFETY RESPONSIBILITIES

## SAFETY IS YOUR NUMBER ONE RESPONSIBILITY!!!!

- At home, in the field, at the range, or anywhere, the first concern of every firearm owner should be safety. Apply the following safety rules in every situation, with any kind of firearm. If you feel uncertain about any operational aspects of your firearm, please contact Smith & Wesson at 1-800-331-0852, ext. 4125 before proceeding with its operation.
- If you are unfamiliar with firearms you should seek formal training before using your pistol.



**WARNING: YOU MUST FOLLOW ALL OF THESE SAFETY RULES TO ENSURE THE SAFE USE OF YOUR FIREARM. THE FAILURE TO FOLLOW THE INSTRUCTIONS AND WARNINGS IN THIS MANUAL COULD CAUSE SERIOUS PERSONAL INJURY OR DEATH TO YOU OR OTHERS AND DAMAGE TO PROPERTY.**

- As a firearm owner, you accept a demanding responsibility. How seriously you take this responsibility can be the difference between life and death. There is no excuse for careless or abusive handling of your firearm. At all times handle your firearm with intense respect for its power and potential danger.

---

## YOUR SAFETY RESPONSIBILITIES CONTINUED

---

- **ALWAYS KEEP YOUR FIREARM POINTED IN A SAFE DIRECTION.** Never point a firearm at anyone or anything you do not intend to shoot whether or not it is loaded. This is particularly important when loading, unloading, or field stripping the gun. ALWAYS control the direction of the firearm.
- **ALWAYS TREAT EVERY FIREARM AS IF IT IS LOADED AND WILL FIRE.** Do not take anyone's word that the firearm is unloaded – always check for yourself. Never pass your firearm to another person until the cylinder or action is open and you visually check that it is unloaded. If possible, the safety should be engaged as well. Keep your firearm unloaded and safely stored when not in use.
- **NEVER PLACE YOUR FINGER INSIDE THE TRIGGER GUARD OR ON THE TRIGGER UNLESS YOU INTEND TO FIRE.** Ensure that other objects do not touch the trigger.
- **ALWAYS BE SURE OF YOUR TARGET AND WHAT IS BEYOND IT.** Always be sure of where the bullet will strike and shoot only where there is a safe backstop free of obstructions, water or other surfaces which can cause ricochets. Be sure your bullet will stop behind your target. Bullets can glance off many surfaces like rocks or the surface of water and travel in unpredictable directions with considerable velocity. Do not fire randomly into the sky.
- **NEVER CROSS OBSTACLES SUCH AS FENCES OR STREAMS WITH A LOADED FIREARM.** Always make certain your firearm is unloaded before crossing a fence, climbing a tree, jumping a ditch or negotiating other obstacles.
- **SAFE GUN HANDLING IS YOUR PERSONAL RESPONSIBILITY AT ALL TIMES.** Firearms can be dangerous and can cause serious injury or death if they are misused or used inappropriately. Safety must be the prime consideration of any one who owns or handles firearms. Accidents are the result of violating the rules of safe gun handling and common sense. Firearm safety training is available. Contact your firearms dealer, law enforcement agency, local sportsman's club, the NRA, etc. for availability.
- **YOU ARE RESPONSIBLE FOR THE FIREARM AT ALL TIMES.** In owning a firearm, you must undertake full-time responsibility for your firearm's safety and security. You must protect yourself and all others against injury or death from misuse of the firearm 24 hours a day.
- **FIREARM SECURITY IS YOUR RESPONSIBILITY.** You must secure firearms safely from children and/or unauthorized users. Your firearm should always be kept unloaded and locked when not in use. A lock has been provided for this purpose. Never assume that the use of a lock is sufficient to safely secure your firearm. You must always evaluate your personal situation and employ the security systems that meet your needs and prevent children and unauthorized users from gaining access to your firearm.

---

## YOUR SAFETY RESPONSIBILITIES CONTINUED

---

- **APPROPRIATE USE FOR YOUR FIREARM MEANS USING YOUR FIREARM FOR LEGAL PURPOSES.** For example - target shooting, hunting and lawful resistance of deadly criminal force. It is your responsibility to ensure that you are in compliance with all applicable laws and ordinances regarding the use of your firearm.
- **NEVER RELY ON MECHANICAL FEATURES ALONE.** Only your safe gun-handling habits will ensure the safe use of your firearm. This is your responsibility.
- **ALWAYS SAFELY STORE AND SECURE YOUR FIREARM.** Safe and secure storage of your firearm is one of your most important responsibilities. It is a full-time responsibility. You must always secure your firearm and ammunition separately so that they are not accessible to children and/or other unauthorized persons.
- **NEVER KEEP AMMUNITION IN THE SAME LOCATION AS THE FIREARM.** Store each in a separate and secure place.
- **ALWAYS WEAR EYE PROTECTION THAT IS SPECIFIED FOR USE WITH FIREARMS** every time you handle your firearm for cleaning and maintenance.
- **ALWAYS WEAR EYE AND HEARING PROTECTION THAT ARE SPECIFIED FOR USE WITH FIREARMS** every time you discharge your firearm. Make sure others in the vicinity of where you will be shooting do so as well.
- **NEVER USE ALCOHOL OR DRUGS BEFORE OR WHILE SHOOTING.** Do not use your firearm if you are on any medication which impairs, even slightly, your mental or physical ability.
- **ALWAYS HAVE ADEQUATE VENTILATION.** Discharging firearms in poorly ventilated areas, cleaning firearms, or handling ammunition may result in exposure to lead and other substances known to cause birth defects, reproductive harm, and other serious physical injury. Review the warnings and labels for all ammunition and cleaning products carefully. Wash hands thoroughly after exposure.
- **BEFORE HANDLING ANY FIREARM, UNDERSTAND ITS OPERATION.** Not all firearms are the same. Familiarize yourself with the mechanical features of any firearm you intend to use. If you feel uncertain about any operational aspects of your firearm, please contact Smith & Wesson at 1-800-331-0852, ext. 4125 before proceeding with its operation.
- **NEVER ALLOW A FIREARM TO BE USED BY INDIVIDUALS WHO DO NOT UNDERSTAND ITS SAFE OPERATION OR HAVE NOT READ THESE FIREARM SAFETY RULES.**

---

## YOUR SAFETY RESPONSIBILITIES CONTINUED

---

- **ALWAYS USE THE CORRECT AMMUNITION FOR YOUR PARTICULAR FIREARM** as indicated by the marking on the firearm. Never use non-standard, damaged, corroded or reloaded (hand-loaded) ammunition which has not been subjected to internal ballistic pressure testing.
- **BEWARE OF BARREL OBSTRUCTIONS** Be sure the barrel is clear of obstructions before shooting. Mud, water, snow or other objects may inadvertently lodge in the barrel bore. A small obstruction can cause a dangerous increase in pressure and may damage your gun and cause injury to yourself and others.
- **BE SURE ALL ACCESSORIES, SUCH AS HOLSTERS, GRIPS, SLINGS, SCOPES AND OTHER ACCESSORIES ARE COMPATIBLE** with the firearm and that the accessories do not interfere with safe operation. It is your responsibility to understand and follow all of the instructions in this manual, as well as those which may be supplied with your ammunition and any accessory.
- **NEVER DISASSEMBLE YOUR FIREARM** beyond the field stripping procedure outlined in this manual. Improper disassembly or reassembly of your firearm may be dangerous and can lead to serious injury or death.
- **NEVER MANIPULATE, ADJUST OR CHANGE ANY OF THE INTERNAL COMPONENTS OF YOUR FIREARM UNLESS SPECIFICALLY INSTRUCTED TO DO SO IN THIS MANUAL.** Improper manipulation of any internal component may affect the safety and reliability of your firearm and may cause serious injury or death.
- **NEVER ALLOW ANY ALTERATION OR REPLACEMENT OF PARTS IN YOUR SMITH & WESSON FIREARM UNLESS PERFORMED BY A QUALIFIED GUNSMITH** using genuine Smith & Wesson parts. If you do otherwise, improper functioning of your firearm may occur and serious injury or death and damage to property may result.



**WARNING: SAFE USE OF A FIREARM IS YOUR PERSONAL RESPONSIBILITY AND THE FAILURE TO FOLLOW ALL OF THESE BASIC SAFETY RULES MAY RESULT IN SEVERE PERSONAL INJURY OR DEATH TO YOU OR OTHERS AND DAMAGE TO PROPERTY. YOU ARE THE MOST IMPORTANT SAFETY DEVICE WHEN IT COMES TO THE USE OF YOUR FIREARM AND SMITH & WESSON WILL NOT BE RESPONSIBLE FOR ANY PERSONAL INJURY, DEATH OR PROPERTY DAMAGE THAT RESULTS FROM:**

- (1) THE CRIMINAL OR NEGLIGENT USE OF THIS FIREARM;
- (2) A DISREGARD OF THESE SAFETY INSTRUCTIONS AND WARNINGS;
- (3) IMPROPER OR CARELESS HANDLING OF THIS FIREARM;
- (4) THE USE OF NON-STANDARD, DEFECTIVE, OR IMPROPER AMMUNITION;
- (5) IMPROPER OR NEGLIGENT MODIFICATIONS OR REPAIRS TO THE FIREARM.

---

# SAFE STORAGE AND TRANSPORTATION

---



**WARNING: ALWAYS POINT THE MUZZLE IN A SAFE DIRECTION.**



**WARNING: FIREARMS ARE DANGEROUS WHEN USED AND STORED IMPROPERLY. THEY POSE A RISK OF SERIOUS OR FATAL INJURIES. FIREARMS CAN BE ESPECIALLY DANGEROUS TO CHILDREN WHEN THEY ARE STORED IN AN IRRESPONSIBLE AND UNSAFE MANNER. FOR YOUR SAFETY AND THE SAFETY OF OTHERS, IT IS IMPERATIVE THAT YOU KEEP YOUR FIREARM LOCKED AND UNLOADED IN A SECURE PLACE. THE AMMUNITION SHOULD BE STORED IN A SEPARATE, SECURE LOCATION WHEN IT IS NOT IN USE. SAFE AND SECURE STORAGE OF YOUR FIREARM IS ONE OF THE MOST IMPORTANT RULES OF FIREARM SAFETY. YOUR FAILURE TO FOLLOW THESE RULES MAY RESULT IN SERIOUS INJURY OR DEATH TO YOU OR OTHERS.**

- **ALWAYS SECURE YOUR FIREARM IN A MANNER THAT WILL PREVENT UNAUTHORIZED ACCESS.** Whenever your firearm is not in use, keep it unloaded and locked. Your safety and the safety of others requires that you always secure and store your firearm in a manner that will prevent unauthorized access. Never leave a firearm unattended unless it is locked, unloaded and secured.
- **ALWAYS USE THE LOCK PROVIDED BY SMITH & WESSON TO SECURE YOUR FIREARM.** Please read and follow the instructions packaged separately for the use of this lock. A lock, when properly used, can be an effective tool in preventing unauthorized access to your firearm. There are other alternative locks and safe storage containers available in the marketplace which may also be appropriate for your particular needs. Consult your local gun shop, hardware store, or local police department for guidance on the variety of other safe storage devices or practices which may be appropriate for your particular needs. By purchasing this firearm you have accepted the responsibility of safely securing the firearm at all times and preventing its unauthorized use. Never assume that the use of this lock alone is sufficient to safely secure your firearm. It is your personal responsibility to select and use whatever measures or practices that will enable you to be absolutely certain that your firearm is secure at all times.



**WARNING: NEVER LOCK A LOADED FIREARM AND NEVER LOAD A LOCKED FIREARM!!**

- **ALWAYS STORE YOUR FIREARM AND AMMUNITION SEPARATELY** so that they are not accessible to children or other unauthorized persons. Safe and secure storage of your firearm and ammunition are your responsibility. It is a full-time responsibility.

---

## SAFE STORAGE & TRANSPORTATION CONTINUED

---

- **NEVER ASSUME THAT A “HIDING” PLACE IS A SECURE STORAGE METHOD.** Others may be aware of your storage location or come upon it by chance. It is your personal responsibility to use common sense when storing your firearm and ammunition and to always make sure they are not accessible to children or other unauthorized persons.
- **NEVER TRANSPORT A LOADED FIREARM.** When transporting your firearm, be sure it is unloaded and locked. Safe and secure transportation of your firearm is your responsibility.
- **ALWAYS FOLLOW THE LAW!** Many jurisdictions have laws that make it a crime to keep a firearm unlocked and in an area accessible to children or others. Keeping a firearm locked and unloaded when not in use is not only common sense safety practice... IT IS THE LAW. You must be familiar with all local, state, and federal laws regarding the safe storage and transportation of your firearm. Failure to know and follow the law may result in unauthorized access or use of your firearm by another. Obey all laws relating to the storage and transportation of firearms. Your local police department or gun shop can furnish you with available information on storing and/or transporting a firearm safely and legally.
- **YOUR FIREARM IS YOUR RESPONSIBILITY.** You must prevent your firearm from being stolen or from being used by untrained or unqualified individuals. Keep it locked, unloaded and secured when not in use.

---

## AMMUNITION

---

 **WARNING: NEVER USE AMMUNITION NOT SPECIFICALLY DESIGNATED FOR USE IN YOUR FIREARM. FAILURE TO USE THE CORRECT TYPE OR CALIBER OF AMMUNITION MAY CAUSE THE FIREARM TO JAM, OR FAIL TO FIRE, OR MAY GENERATE EXCESSIVE PRESSURE WHICH CAN DAMAGE OR EVEN RUPTURE YOUR FIREARM, CAUSING PERSONAL INJURY OR DEATH TO THE SHOOTER OR BY-STANDERS.**

- Locate the cartridge designation marked on the firearm. This information indicates the correct ammunition that must be used in this firearm (FIG. 1).
- You are responsible for selecting ammunition that meets industry standards and is appropriate in type and caliber for this firearm.
- Never mix ammunition.





---

## AMMUNITION CONTINUED

---



**WARNING: IN SOME CASES, A ROUND OF AMMUNITION NOT SPECIFIED ON YOUR FIREARM AND NOT LISTED AS ALTERNATE AMMUNITION IN THIS MANUAL, MAY FIT INTO THE CHAMBER. FIRING THIS AMMUNITION MAY CAUSE A RUPTURE RESULTING IN DAMAGE TO THE FIREARM AND PERSONAL INJURY OR DEATH TO THE SHOOTER OR BYSTANDERS. FOR MORE INFORMATION REGARDING UNSAFE CALIBER COMBINATIONS, REFER TO THE FOLLOWING URL: [HTTPS://SAAMI.ORG/TECHNICAL-INFORMATION/UNSAFE-FIREARM-AMMUNITION-COMBINATIONS/](https://saami.org/technical-information/unsafe-firearm-ammunition-combinations/)**



**WARNING: ALWAYS INSPECT YOUR AMMUNITION BEFORE USING IT. NEVER USE DIRTY, CORRODED OR DAMAGED AMMUNITION. A BURST CARTRIDGE MAY RESULT CAUSING DAMAGE TO THE FIREARM AND PERSONAL INJURY OR DEATH TO THE SHOOTER OR BYSTANDERS.**

- Use only commercially manufactured ammunition with internal ballistic pressures which are in strict accordance with the specifications of the Sporting Arms and Ammunition Manufacturers' Institute (SAAMI). If you are uncertain, contact your ammunition supplier for verification.
- Smith & Wesson has found wide variations in primer sensitivity between different brands and types of 22LR ammunition. Smith & Wesson recommends that before you put your 22LR handgun into regular use, that you fire several boxes of your brand of ammunition through it to determine reliability of ignition. If "failure to fire" occurs, try different types or brands of 22LR ammunition until a reliable loading is found.



**WARNING: NEVER USE NON-STANDARD, RELOADED OR "HANDLOADED" AMMUNITION WHICH HAS NOT BEEN SUBJECTED TO INTERNAL BALLISTIC PRESSURE TESTING. RELOADED OR HANDLOADED AMMUNITION, MAY HAVE MANY MANUFACTURING AND QUALITY VARIABLES (SUCH AS THE TYPE AND AMOUNT OF GUN POWDER). CARTRIDGE CASES THAT HAVE BEEN RELOADED AND FIRED MULTIPLE TIMES MAY SUFFER PHYSICAL DAMAGE WHICH COULD SIGNIFICANTLY IMPACT OR REDUCE THE INTEGRITY OF THE CARTRIDGE, POSSIBLY RESULTING IN BULLET SETBACK OR UNSEATING. CASE FAILURE AND INJURY TO THE SHOOTER OR BYSTANDERS AND DAMAGE TO THE FIREARM MAY RESULT WHEN SUCH A ROUND IS FIRED. ANY AMMUNITION THAT IS IMPROPERLY MANUFACTURED OR RELOADED, EVEN IN THE SLIGHTEST DEGREE, MAY FAIL TO FIRE OR MAY GENERATE EXCESSIVE INTERNAL PRESSURES WHICH CAN DAMAGE OR EVEN RUPTURE THE FIREARM, CAUSING PERSONAL INJURY OR DEATH TO THE SHOOTER OR THOSE IN THE IMMEDIATE VICINITY.**

---

## AMMUNITION CONTINUED

---

- A firearm and ammunition are a system and must work together. There are different types of ammunition for different types of firearms. Your firearm has been designed for ammunition of a specific type and a specific gauge or caliber. It is important to select the proper ammunition for your firearm.
- Use of hyper-velocity ammunition in this pistol may affect wear characteristics and may result in the need for more frequent service and/or replacement of parts.



**WARNING: NEVER USE AMMUNITION OF THE INCORRECT GAUGE OR CALIBER. USING AMMUNITION OF THE INCORRECT GAUGE OR CALIBER MAY CAUSE DAMAGE TO YOUR FIREARM AND POSSIBLE SERIOUS INJURY TO YOU AND TO OTHERS.**



**WARNING: NEVER USE CARTRIDGES OTHER THAN THOSE DESIGNATED BY THE MARKING ON THE FIREARM. DOING SO CAN RESULT IN DANGEROUSLY HIGH PRESSURES THAT MAY DAMAGE THE FIREARM AND POSSIBLY CAUSE SERIOUS INJURY TO YOURSELF AND OTHERS.**



**WARNING: DEATH, SERIOUS INJURY AND PROPERTY DAMAGE CAN RESULT FROM THE USE OF INCORRECT AMMUNITION OR BORE OBSTRUCTIONS. NEVER USE RELOADED AMMUNITION THAT HAS NOT BEEN SUBJECTED TO INTERNAL BALLISTIC PRESSURE TESTING. SEE PAGE 9 FOR DETAILS.**

- Some brands of ammunition may cause difficulty in extracting spent cartridge cases from the cylinder or chamber. If this situation occurs, thoroughly clean the cylinder charge holes or chamber with solvent. If this condition persists, we recommend changing to another brand of ammunition.



**WARNING: DISCHARGING FIREARMS IN POORLY VENTILATED AREAS, CLEANING FIREARMS, OR HANDLING AMMUNITION MAY RESULT IN EXPOSURE TO LEAD AND OTHER SUBSTANCES KNOWN TO CAUSE BIRTH DEFECTS, REPRODUCTIVE HARM, AND OTHER SERIOUS PHYSICAL INJURY. HAVE ADEQUATE VENTILATION AT ALL TIMES. WASH HANDS THOROUGHLY AFTER EXPOSURE.**

# MODEL AND FEATURES IDENTIFICATION

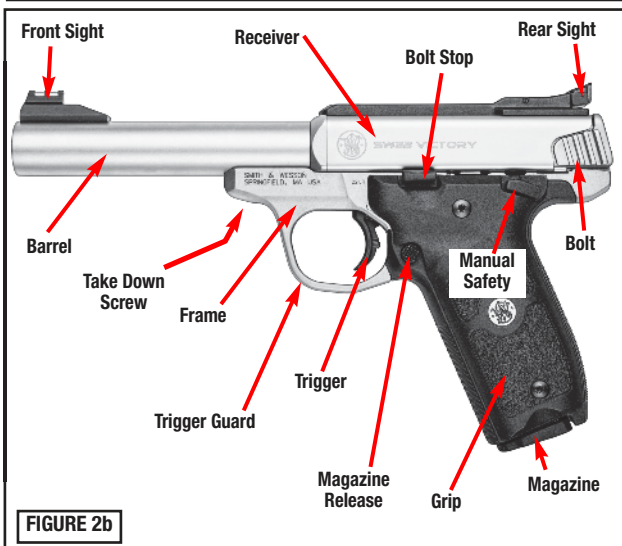
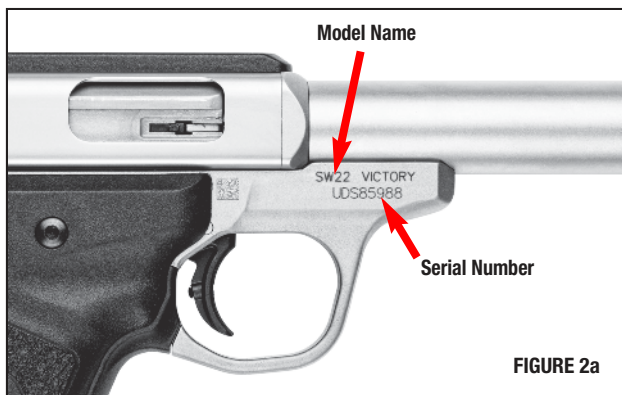

## TRIGGER ADJUSTMENT SCREW(S)

- The trigger overtravel screw on the standard model is factory set and does not require any further adjustment by the user. Some Performance Center® models include the ability to adjust trigger takeup/pretravel and overtravel. See the section titled PERFORMANCE CENTER® TRIGGER ADJUSTMENT in this manual for information on how to adjust the trigger on those models so-equipped.

# INSPECTING YOUR PISTOL

**WARNING: ALWAYS ENSURE THAT THE FIREARM IS UNLOADED BEFORE INSPECTING, DISASSEMBLING, ASSEMBLING OR CLEANING AND ALWAYS KEEP THE MUZZLE POINTED IN A SAFE DIRECTION.**

- Check for yourself to ensure that the firearm is unloaded. To do this, grasp the pistol with your finger off the trigger and outside the trigger guard, point the pistol in a safe direction, depress the magazine release and remove the magazine (FIGURE 3).

- Point the muzzle in a safe direction, grasp the serrated sides of the bolt from the rear with the thumb and fingers (FIGURE 4) and briskly draw the bolt fully rearward to extract any cartridge from the barrel chamber and clear it from the pistol. Do not obstruct the ejection port because doing so can interfere with ejection of a cartridge.

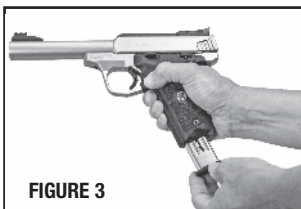

- Lock the bolt in the open position, by allowing the bolt to move slightly forward from the rear-most position while pressing upward on the bolt stop (FIGURE 4).

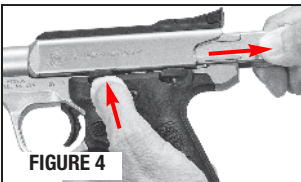

- Check the barrel chamber and bore visually for any cartridges or obstructions (FIGURE 5).



- Observe the breech face to ensure that the firing pin is not protruding from the breech face (FIGURES 6a and 6b).

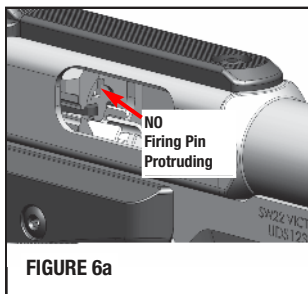

- Before using your firearm for the first time, it should be cleaned.

---

## INSPECTING YOUR PISTOL CONTINUED

---

- Ensure that the bolt moves freely along its full length of travel (FIGURES 7a & 7b). Lock the bolt in the “open” position as described previously in this manual.

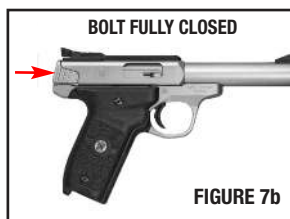
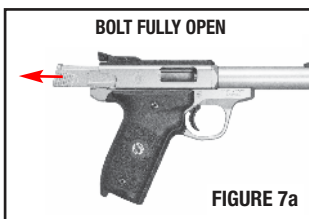

**WARNING:** VERIFY THAT THE FIRING PIN IS NOT PROTRUDING FROM THE BREECH FACE. IF THE FIRING PIN IS PROTRUDING, MAKE SURE THE FIREARM IS POINTED IN A SAFE DIRECTION, UNLOAD THE FIREARM AND HAVE IT INSPECTED AND TEST FIRED BY A GUNSMITH QUALIFIED TO PERFORM SERVICE ON SMITH & WESSON FIREARMS.

- You must follow this procedure every time your firearm leaves your hand, is cleaned, handed to another person, transported or stored.

---

## PREPARATION FOR FIRING

---

**WARNING:** THE FAILURE TO FOLLOW THESE FIREARM SAFETY REQUIREMENTS WILL CAUSE SERIOUS PERSONAL INJURY OR DEATH TO YOU OR OTHERS.

- **ALWAYS TREAT ALL FIREARMS AS IF THEY ARE LOADED.**
- **ALWAYS BE SURE THAT THE CHAMBER IS CLEAR OF A CARTRIDGE, THE MAGAZINE IS REMOVED OR UNLOADED, AND THAT THE FIREARM IS POINTING IN A SAFE DIRECTION.**
- **ALWAYS KEEP FINGERS AND OTHER PARTS OF YOUR BODY AWAY FROM THE MUZZLE AND AWAY FROM THE PISTOL BOLT AND EJECTION PORT.**
- **ALWAYS WEAR ADEQUATE AND PROPER HEARING PROTECTION SPECIFIED FOR FIREARM USE** to prevent permanent damage to your hearing. Make sure others who are nearby are wearing hearing protection as well.
- **ALWAYS WEAR SAFETY GLASSES SPECIFIED FOR FIREARM USE**, whether indoors or out. Safety glasses should protect your eyes from the firing flash and particles associated with the discharge of ammunition. Failure to do so creates a risk of personal injury from particle or debris spitting or a ricochet.

---

## PREPARATION FOR FIRING CONTINUED

---

- **ALWAYS BE ALERT AND ALWAYS FOLLOW THE SAFETY INSTRUCTIONS OF THE RANGE OFFICER.** Never shoot if you are tired, cold or impaired in any way.
- **ALWAYS BE AWARE OF OTHER PEOPLE** so that persons do not accidentally walk into the line of fire.
- **THE SHOOTER (AND ALL OTHERS IN THE SHOOTING AREA) MUST ALWAYS BE IN A POSITION THAT IS OUT OF THE LINE OF FIRE** and are not within an area where they may be struck by a ricochet or particles spitting from a firearm, or by ejected cases from some types of firearms.
- **NEVER SHOOT AT SURFACES THAT MAY CAUSE A RICOCHET.** Always select a place to shoot that has a safe backstop, is free from obstructions and has no surfaces which may cause a ricochet.
- **NEVER FIRE RANDOMLY INTO THE SKY.** Always select a place to shoot that has a safe backstop.
- **NEVER USE ALCOHOL OR DRUGS BEFORE OR WHILE SHOOTING OR HANDLING ANY FIREARM.**

---

## LOADING

---



**WARNING: ALWAYS KEEP THE MUZZLE POINTED IN A SAFE DIRECTION.**



**WARNING: NEVER RELY ON MECHANICAL FEATURES ALONE. ONLY YOUR SAFE GUN HANDLING WILL ENSURE THE SAFE USE OF YOUR FIREARM. THIS IS YOUR RESPONSIBILITY.**



**WARNING: YOUR S&W® SW22 VICTORY® PISTOL IS EQUIPPED WITH A MAGAZINE SAFETY. IN ORDER FOR THE MAGAZINE SAFETY TO OPERATE CORRECTLY, YOU MUST FULLY RELEASE THE TRIGGER AND REMOVE YOUR FINGER FROM WITHIN THE TRIGGER GUARD PRIOR TO THE MAGAZINE BEING REMOVED FROM THE PISTOL. FAILURE TO FULLY RELEASE THE TRIGGER COULD RESULT IN AN ACCIDENTAL DISCHARGE WHEN THE TRIGGER IS THEN PULLED THE REST OF THE WAY REARWARD - REGARDLESS OF THE PRESENCE OF A MAGAZINE IN THE PISTOL. "STAGING" THE TRIGGER (KEEPING TENSION ON THE TRIGGER) VIOLATES A BASIC RULE OF FIREARM SAFETY WHICH WARNS YOU TO KEEP YOUR FINGER OFF THE TRIGGER AND OUT OF THE TRIGGER GUARD UNTIL YOU HAVE MADE THE COMMITMENT TO FIRE. "STAGING" CREATES A SERIOUS RISK OF PERSONAL INJURY OR DEATH SINCE IT MAY LEAD TO AN UNINTENTIONAL DISCHARGE.**

## LOADING CONTINUED

**NOTE:** After inserting a magazine, always test to make sure it is locked in place by applying some removal pressure to the exposed portion of the magazine butt plate.

- Do not load the pistol until you have read and fully understand this manual.
- Do not load the pistol until you are ready to use it. Keep your finger off the trigger and outside the trigger guard until you are ready to fire.
- Never load your pistol until you are sure of your target, what is beyond it and are fully prepared to fire.
- If the magazine is removed for reloading and a round is left in the chamber, be sure to apply the safety and then holster or otherwise secure the pistol under your direct control while the magazine is being reloaded.
- Smith & Wesson has provided you with a magazine designed to operate in your specific model of pistol. While your magazine may be able to be inserted into another model pistol, it will only function properly in the specific model for which it was designed. Do not interchange magazines from one model pistol into another model pistol.
- Follow instructions in this manual and any other specific instructions which may be marked onto, or accompany, a magazine. Failure to use the particular type of Smith & Wesson magazine specified for your model and caliber of pistol may result in a malfunction.
- Load the magazine by first pulling down the follower with the load assist button (just far enough to load one cartridge at a time). Insert a cartridge rim (rear of cartridge) at the notch in the middle of the magazine feed lips and slide the cartridge rearward - fully under the rear lips of the magazine until the cartridge rim is against the back of the magazine (FIGURE 8). Repeat the procedure for the number of cartridges you wish to load, up to the magazine capacity (the magazine holds 10 rounds when fully loaded). Do not attempt to load your magazine with more than the specified number of cartridges because doing so can cause a feeding failure.

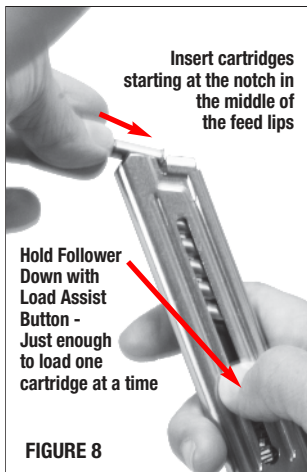

## LOADING CONTINUED

- Place the manual safety in the “SAFE” (up) position (FIG. 9).

**WARNING: VERIFY THAT THE FIRING PIN IS NOT PROTRUDING FROM THE BREECH FACE. IF THE FIRING PIN IS PROTRUDING, MAKE SURE THE FIREARM IS POINTED IN A SAFE DIRECTION, UNLOAD THE FIREARM AND HAVE IT INSPECTED AND TEST FIRED BY A GUNSMITH QUALIFIED TO PERFORM SERVICE ON SMITH & WESSON FIREARMS.**

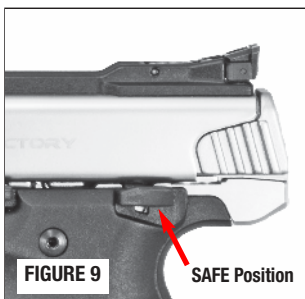

**WARNING: ALWAYS LOAD A ROUND INTO THE CHAMBER BY FEEDING IT FROM THE MAGAZINE. FAILURE TO FOLLOW THIS WARNING CAN RESULT IN SEVERE INJURY OR DEATH TO YOU OR OTHERS. NEVER ATTEMPT TO LOAD THE PISTOL BY INSERTING A ROUND INTO THE OPEN EJECTION PORT.**

- Inspect your pistol as previously described in the “Inspecting Your Pistol” section. Lock the bolt to the rear with the bolt stop and verify that the chamber is empty. Hold the pistol in one hand with the muzzle pointing in a safe direction and with your finger off the trigger and outside the trigger guard. Insert the loaded magazine into the magazine well of the pistol until it is locked in place.

**WARNING: DO NOT USE EXCESSIVE UPWARD FORCE WHEN INSERTING A LOADED MAGAZINE INTO THE PISTOL. EXCESSIVE UPWARD FORCE COULD CAUSE THE BOLT TO MOVE FORWARD, CHAMBERING A ROUND AND MAKING THE PISTOL READY TO FIRE.**

- Make sure that the magazine is fully and securely inserted by applying some downward pressure to the exposed portion of the magazine butt plate.
- Press down on the bolt stop to release the bolt and allow it to carry fully forward under spring tension. This strips a cartridge from the magazine and seats it in the chamber of the barrel.
- Or, load the chamber by grasping the serrated sides of the bolt from the rear with the thumb and fingers, with the muzzle pointing in a safe direction, briskly draw the bolt fully rearward and release it. This strips a cartridge from the magazine and seats it in the chamber of the barrel. Let the bolt move forward under its own spring tension, do not interfere with the bolt’s forward movement with your hand.

**WARNING: THE PISTOL WILL FIRE IF THE MANUAL SAFETY IS PLACED IN THE FIRE (DOWN) POSITION AND THE TRIGGER IS PULLED.**



## LOADING CONTINUED

**WARNING: IF THE CARTRIDGE FAILS TO STRIP FROM THE MAGAZINE OR FULLY SEAT INTO THE CHAMBER, IMMEDIATELY STOP THE LOADING PROCESS. REMOVE THE MAGAZINE, LOCK THE BOLT OPEN AND VERIFY THAT THE CHAMBER IS EMPTY. REFER TO THE “INSPECTING YOUR PISTOL SECTION” OF THIS MANUAL.**

- Remember to keep your pistol pointed in a safe direction under all conditions and always keep your finger or any other object off the trigger and outside the trigger guard until you have made the commitment to fire the handgun. Never leave a loaded firearm unattended.

## FIRING

**WARNING: ALWAYS KEEP THE MUZZLE POINTED IN A SAFE DIRECTION.**

**WARNING: WEAR EYE AND HEARING PROTECTION SPECIFIED FOR FIREARM USE EVERY TIME YOU DISCHARGE YOUR FIREARM. MAKE SURE OTHERS IN THE VICINITY OF WHERE YOU WILL BE SHOOTING DO SO AS WELL.**

**WARNING: UPON FIRING THE PISTOL OR RELEASING THE BOLT FROM THE BOLT STOP, THE BOLT MOVES REARWARD OR FORWARD WITH SIGNIFICANT FORCE AND SPEED. TO AVOID INJURY BE SURE NO PART OF YOUR BODY IS IN THE PATH OF THE BOLT’S TRAVEL.**

- Keep your finger outside the trigger guard until you are ready to fire. Push the manual safety into the “FIRE” (down) position (FIGURE 10).
- While holding the grip firmly, pull the trigger fully to the rear to fire the round (FIGURE 11).
- Upon firing, the bolt moves rearward with considerable force thereby extracting and ejecting the spent cartridge case. The bolt then returns forward, under spring tension, feeding the next cartridge from the magazine into the barrel chamber and the pistol is again ready to fire with a pull of the trigger.



## FIRING CONTINUED

- Allow the trigger to move fully forward after firing, before you attempt to fire another shot. Failure to do so will prevent the lockwork from fully cycling and will prevent the firearm from being able to fire the next shot. Keep your finger off the trigger and outside the trigger guard until you are ready to fire again. This sequence can be repeated until the last round has been fired, at which time the magazine follower exerts upward pressure on the bolt stop causing it to engage the bolt and to hold it in the “open” position.

**WARNING: EXCEPT AS DIRECTED IN THE SECTION OF THIS MANUAL THAT COVERS SW22 VICTORY PERFORMANCE CENTER TRIGGER ADJUSTMENT (FOR THOSE MODELS SO-EQUIPPED), DO NOT DRY FIRE YOUR PISTOL, AS DAMAGE TO THE PISTOL MAY RESULT.**

## CLEARING MISFIRES

**WARNING: IF YOUR HANDGUN GIVES ANY INDICATION THAT IT IS NOT PERFORMING PROPERLY OR THE OPERATION OF YOUR HANDGUN HAS CHANGED “THE WAY IT FEELS OR SOUNDS”, STOP FIRING. MAKE SURE THE FIREARM IS POINTED IN A SAFE DIRECTION, UNLOAD THE FIREARM AND HAVE IT INSPECTED AND TEST FIRED BY A GUNSMITH QUALIFIED TO PERFORM SERVICE ON SMITH & WESSON FIREARMS.**

- If a cartridge fails to fire, the chamber must be manually cleared.
- Wait thirty seconds while keeping the muzzle pointed in a safe direction.
- Keep your finger off the trigger and out of the trigger guard.
- Remove the magazine (FIGURE 12).
- Grasp the serrated sides of the bolt from the rear and briskly pull the bolt fully rearward to eject the misfired round. Do not obstruct the ejection port, and do not attempt to catch the round by placing your hand over the ejection port (FIGURE 13).
- Lock the bolt in the open position by allowing the bolt to move slightly forward from the rearmost position while pressing upward on the bolt stop. You are now able to safely check the barrel chamber and bore visually for any obstructions.

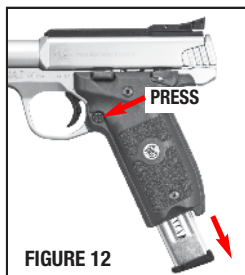

FIGURE 12

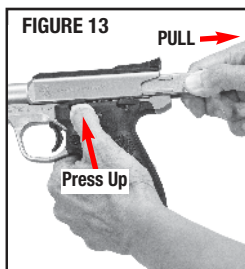

FIGURE 13

## CLEARING MISFIRES CONTINUED

- It may be necessary to manually remove a jammed cartridge. When attempting to clear a jam manually, use only wood 'tools', such as a pointed dowel, and use extreme care to avoid striking the rim/primer of the cartridge.
- Look into the chamber and down through the magazine well. Verify that no ammunition remains in the pistol (FIGURE 17).

## UNLOADING



**WARNING: ALWAYS KEEP THE MUZZLE POINTED IN A SAFE DIRECTION.**

- Point the muzzle in a safe direction. Make sure your finger is off the trigger and out of the trigger guard. Verify that the manual safety is in the safe (up) position. Depress the magazine release, and remove the magazine (FIGURE 14).
- With the muzzle still pointing in a safe direction, and with your finger off the trigger and outside the trigger guard, grasp the sides of the bolt from the rear with your thumb and fingers, and briskly draw the bolt fully rearward in order to extract any cartridge from the barrel chamber and clear it from the pistol. Do not obstruct the ejection port because doing so can interfere with ejection of a cartridge (FIGURE 15).
- Lock the bolt to the rear by pushing the bolt stop lever upwards while pulling the bolt back and then allowing it to go forward slightly to be held rearward by the bolt stop lever.
- Unload the magazine by holding it with the bullet end of the cartridge pointing away from you and pressing each cartridge forward and out of the magazine (FIGURE 16a & 16b). It helps to hold the load assist button down slightly to remove tension on the cartridge as you push each one out of the magazine.
- Look into the chamber and down through the magazine well. Verify that no ammunition remains in the pistol (FIGURE 17).

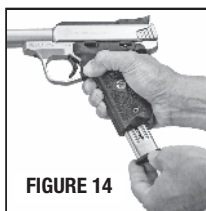

FIGURE 14



FIGURE 15

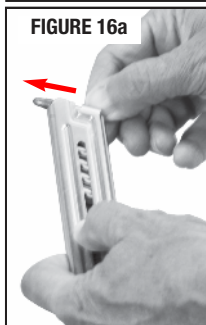

FIGURE 16a

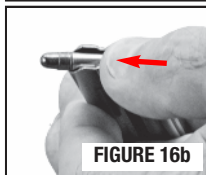

FIGURE 16b



FIGURE 17

## REAR SIGHT ADJUSTMENT



**WARNING: ALWAYS ENSURE YOUR FIREARM IS UNLOADED BEFORE ADJUSTING YOUR SIGHTS. AT ALL TIMES FOLLOW THE BASIC RULES OF SAFE GUN HANDLING.**

- The rear sight (FIGURE 18) is fully adjustable for both windage and elevation. The top screw controls the elevation and each click raises or lowers the point of impact at the target. The windage adjustment screw, located on the right side of the body, controls the windage and each click moves the point of impact right or left at the target.

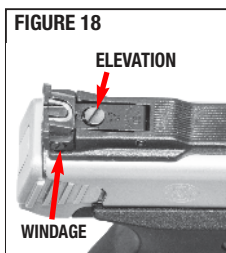

### ADJUSTING FOR ELEVATION

- Rotate the adjusting screw on the top of the rear sight clockwise to lower the rear sight (lowering the rear sight will lower the group on target) or turn it counter-clockwise to raise the rear sight (raising rear sight will raise the group on target).

### ADJUSTING FOR WINDAGE

- Rotate the adjusting screw on the right side of the rear sight clockwise to move the rear sight blade to the right (moving rear sight blade to the right will move the group to the right on target) or counter-clockwise to move it to the left (moving the rear sight blade to the left will move the group to the left on target).

## OPTICAL SIGHT MOUNT



**WARNING: ALWAYS ENSURE THAT THE FIREARM IS UNLOADED BEFORE INSTALLING A SCOPE OR ANY OTHER ACCESSORIES. FAILURE TO DO THIS CAN CAUSE PERSONAL INJURY OR DEATH TO YOU OR OTHERS.**

- The SW22 VICTORY® is factory drilled and tapped to accept a scope mount base. No additional holes need to be drilled. Different scopes have varying lengths of eye relief. You need to choose a combination that allows for adequate clearance between the scope and your eye. Follow the instructions supplied with the scope and rings for proper installation.
- We recommend that you have a competent gunsmith install your optical sight mount and sight/scope.
- If you decide to mount an optical sight yourself, follow these instructions.

## OPTICAL SIGHT MOUNT CONTINUED

- As delivered from the factory, the pistol has the adjustable open sight installed. The sight must be removed in order to install the optical sight base in its place (FIGURE 19).

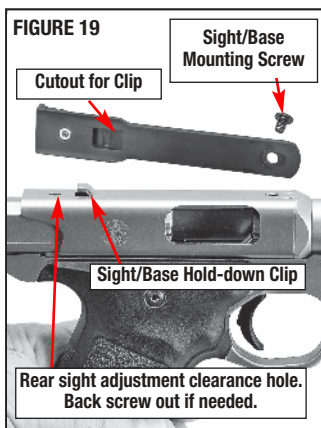

- Remove the hex head screw from the front of the rear sight base, using a 3/32" hex wrench (FIGURE 20), turning the screw counter-clockwise as viewed from the top of the pistol.



- Slide the entire sight base rearward to disengage the clip that holds the rear sight down on the receiver (FIGURE 21).

**NOTE:** If the rear sight elevation screw is turned down so the shank of it protrudes into the hole in the receiver, turn the elevation screw 2 turns counter-clockwise to raise the screw out of the hole so you can push the sight base rearward and detach the sight from the clip.

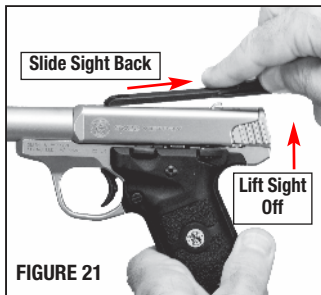

- Set the rear sight aside in a place where you can find it when you would like to reinstall it.

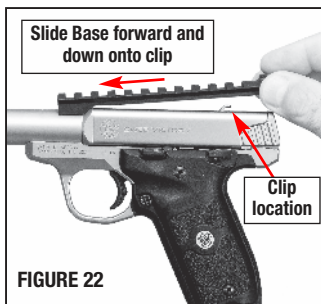

- Slide the optical sight base forward along the top of the receiver to engage the clip that holds the base down onto the rear of the pistol's receiver (FIGURE 22).

## OPTICAL SIGHT MOUNT CONTINUED

- Align the front screw hole and reinstall the hex head screw, tightening it firmly with a 3/32" hex wrench (FIGURE 23).
- See a video of this procedure at the following address:  
<http://www.smith-wesson.com/firearms/sw22-victory>

- Follow the instructions provided by the scope ring or optical sight maker to complete the installation.



**WARNING:** FIRING A SCOPED FIREARM WITH YOUR EYE TOO CLOSE TO THE SCOPE EYE PIECE, OR FAILING TO HOLD THE FIREARM SECURELY AGAINST RECOIL, MAY RESULT IN SERIOUS PERSONAL INJURY INCLUDING, BUT NOT LIMITED TO, BLINDNESS.

**WARNING:** DO NOT DRILL ADDITIONAL HOLES IN THE FIREARM AS THIS COULD WEAKEN ITS STRUCTURE AND CONTRIBUTE TO A RUPTURE CAUSING INJURY AND/OR DEATH TO THE SHOOTER OR BYSTANDERS AND DAMAGE TO PROPERTY. DOING SO WILL VOID YOUR WARRANTY.

**WARNING:** AN OPTICAL SIGHT OR SIGHT MOUNT WHICH IS NOT SECURELY MOUNTED MAY BECOME DETACHED UPON RECOIL OF THE FIREARM. IF IT BECOMES DETACHED, THE OPTICAL SIGHT MAY FLY BACK AND STRIKE THE SHOOTER OR A BYSTANDER AND CAUSE INJURY. CHECK THE CONDITION OF ALL THE OPTICAL SIGHT ATTACHMENT SCREWS AFTER FIRING. IF THE SCREWS BECOME LOOSE, DO NOT FIRE THE PISTOL AGAIN; CALL THE CUSTOMER SERVICE DEPARTMENT FOR ASSISTANCE AT 800-331-0852 EXT. 4125.

- The optical sight base has a non-adjustable built-in rear sight (FIGURE 24).

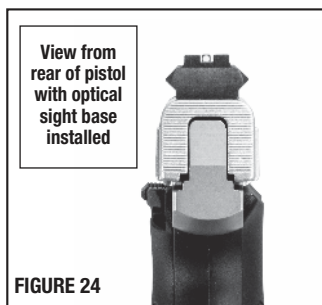

# FIELD STRIPPING / DISASSEMBLY



**WARNING: ALWAYS KEEP THE MUZZLE POINTED IN A SAFE DIRECTION.**



**WARNING: ALWAYS ENSURE THAT THE FIREARM IS UNLOADED BEFORE INSPECTING, DISASSEMBLING OR ASSEMBLING.**



**WARNING: ALWAYS FOLLOW THE FIELD STRIPPING INSTRUCTIONS EXACTLY. NEVER DO ANYTHING BEYOND WHAT YOU ARE SPECIFICALLY INSTRUCTED TO DO IN THIS MANUAL. NEVER ALTER OR MODIFY THE PARTS IN YOUR PISTOL.**



**WARNING: WEAR SAFETY GLASSES EVERY TIME YOU ASSEMBLE OR DISASSEMBLE YOUR FIREARM.**

- Point the pistol in a safe direction. Make sure your finger is off the trigger, and the trigger is in the "at rest" or forward position.



FIGURE 25

- Depress the magazine release, and remove the magazine (FIGURE 25).

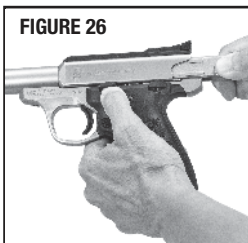

FIGURE 26

- With the barrel still pointing in a safe direction, and with your finger off the trigger and outside the trigger guard, grasp the serrated sides of the bolt from the rear with the thumb and fingers while holding the firearm in an upright position, and briskly draw the bolt fully rearward in order to extract any cartridge from the barrel chamber and clear it from the pistol. Lock the bolt into the open position by pressing the bolt stop lever to the up position (FIGURE 26).



FIGURE 27

- Make certain that the chamber is clear (FIGURE 27).

## FIELD STRIPPING / DISASSEMBLY CONTINUED

- Close the bolt on an empty chamber.
- Using the 1/8" hex wrench provided, loosen the takedown screw (FIGURE 28) by turning it counter-clockwise. This may require significant pressure.
- While holding the barrel and frame together with one hand, remove the takedown screw completely.
- Remove the barrel/receiver assembly from the frame by tipping the muzzle end up slightly (FIGURE 29) and pulling the assembly forward, off the tabs at the rear that hold them together and away from the grip frame (FIGURE 30).

**NOTE:** Once lifted clear of the frame, the bolt is free to slide out the rear of the receiver. Take care not to drop the bolt.

- Grasp the bolt at the serrated area and withdraw it from the receiver (FIGURE 31).

- FIGURE 32 shows the pistol field stripped for cleaning.

### IMPORTANT NOTE:

The recoil spring is compressed within the bolt and will fly out with considerable force if not controlled. It is not required that the recoil spring and guide rod be removed for normal cleaning. Be careful not to unintentionally dislodge the spring and guide rod while cleaning the bolt as the spring will come out with considerable force if dislodged.

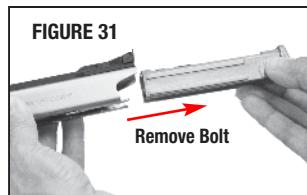
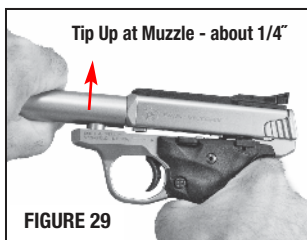
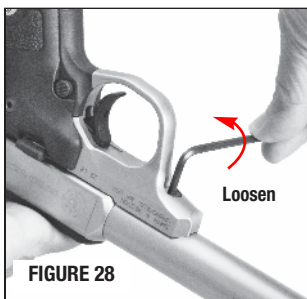



## FIELD STRIPPING / DISASSEMBLY CONTINUED

- The recoil spring (FIGURE 33) is held in place by the guide rod that is in turn held by a cutout in the bolt (FIGURE 34).

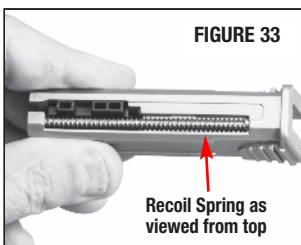

- To remove the guide rod and recoil spring, compress the spring slightly and lift the assembly up and out of its notch from the bottom of the bolt (FIGURE 35).

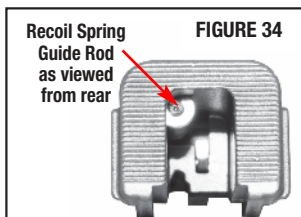

- FIGURE 36 shows the bolt field-stripped for cleaning.

- Reassemble the spring on the guide rod and compress the spring (with the large end of the guide rod to the rear) until the head of the guide rod returns to its cutout in the bolt (FIGURE 37). FIGURE 34 shows the guide rod properly positioned in its cutout.

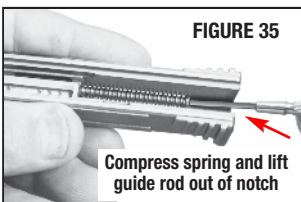

- See a video of this procedure at: <http://www.smith-wesson.com/firearms/sw22-victory>

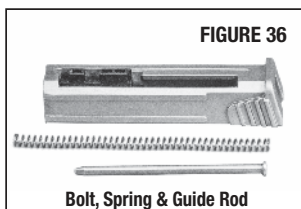

**WARNING: DO NOT DRY FIRE YOUR PISTOL WHEN THE BARREL / RECEIVER IS OFF THE FRAME, AS DAMAGE TO THE PISTOL MAY RESULT.**

**WARNING: DO NOT ALTER, MODIFY OR REPLACE ANY OF THE PARTS OF YOUR FIREARM UNLESS THIS WORK IS PERFORMED BY A QUALIFIED GUNSMITH USING GENUINE SMITH & WESSON PARTS. IF YOU DO OTHERWISE, IMPROPER FUNCTIONING MAY OCCUR AND SERIOUS INJURY MAY RESULT. IT WILL ALSO VOID YOUR WARRANTY.**

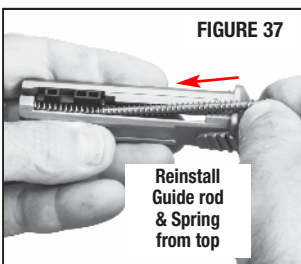

**WARNING: NEVER DISASSEMBLE YOUR HANDGUN BEYOND THE FIELD STRIPPING PROCESS OUTLINED IN THIS MANUAL. NEVER MANIPULATE ANY INTERNAL COMPONENTS BEYOND WHAT YOU ARE SPECIFICALLY INSTRUCTED TO DO IN THIS MANUAL SINCE THIS MAY AFFECT THE RELIABILITY, FUNCTIONING AND SAFETY OF YOUR HANDGUN.**

## BARREL REMOVAL

- Removal of the barrel from the receiver is not necessary for regular cleaning and maintenance. If you wish to remove the barrel from the receiver, follow the steps below:



**WARNING: ALWAYS KEEP THE MUZZLE POINTED IN A SAFE DIRECTION.**



**WARNING: ALWAYS ENSURE THAT THE FIREARM IS UNLOADED WHILE INSPECTING, DISASSEMBLING OR ASSEMBLING.**



**WARNING: WEAR SAFETY GLASSES EVERY TIME YOU ASSEMBLE OR DISASSEMBLE YOUR FIREARM AND ATTEMPT CLEANING OR MAINTENANCE.**

- Field Strip / Disassemble the pistol as detailed in that section of this manual.
- Loosen the barrel set screw at the bottom front of the receiver with the hex wrench provided (FIGURE 38a). Several turns counter-clockwise should suffice. You do not need to completely remove the screw.

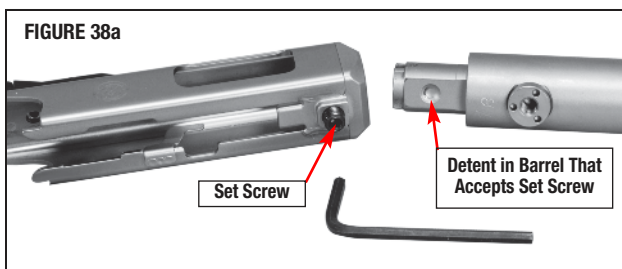

- Grasp the barrel in one hand and the receiver in the other and pull them apart (FIGURE 38b). Some effort may be required if the parts are dirty. The parts are a slip fit - no turning is required or possible.

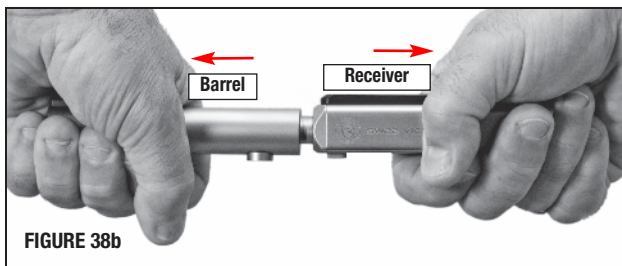

- To reassemble, insert the barrel fully into the receiver. The barrel is shaped in such a way that it will only enter the receiver in the correct orientation. Before assembly, apply a light film of quality gun oil to all metal parts.

## BARREL REMOVAL CONTINUED

- Tighten the barrel set screw until it is snug.
- Reassemble the pistol as instructed in the Field Stripping / Assembly section of this manual.
- Prior to firing, check for proper function of the bolt within the receiver and the pistol's controls.
- Periodically check the tightness of the barrel set screw. Tighten as necessary.
- See a video of this procedure at the following address:  
<http://www.smith-wesson.com/firearms/sw22-victory>

**WARNING: DO NOT ADD OR REPLACE ANY OF THE PARTS IN YOUR FIREARM UNLESS THEY ARE GENUINE SMITH & WESSON PARTS AND YOU FOLLOW THE INSTRUCTIONS SUPPLIED. IF YOU DO OTHERWISE, IMPROPER FUNCTIONING MAY OCCUR AND SERIOUS INJURY OR DEATH MAY RESULT. IN ADDITION TO THE DANGERS PRESENTED, THE USE OF NON-FACTORY PARTS, INCLUDING BUT NOT LIMITED TO BARRELS AND SPRINGS, VOIDS ALL WARRANTIES.**

## LUBRICATION

- Apply a single drop of firearm lubricant to the points shown (FIGURE 39). This will assure proper lubrication of your pistol. Do not over-lubricate. Excess lubricant can collect large quantities of unburned powder and carbon residue, which could interfere with proper functioning of the pistol.

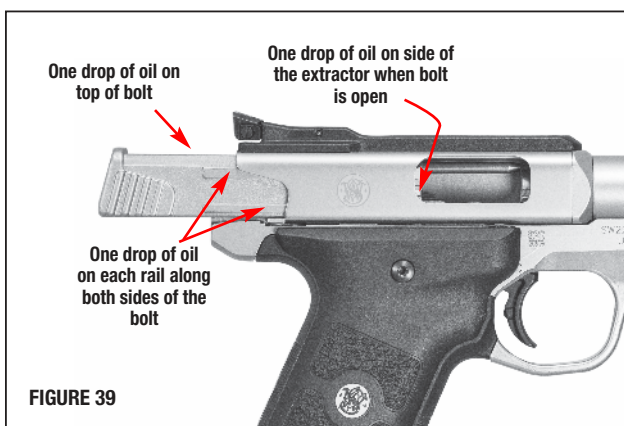

# FIELD STRIPPING/ ASSEMBLY



**WARNING: ALWAYS ENSURE THAT THE FIREARM IS UNLOADED BEFORE INSPECTING, DISASSEMBLING OR ASSEMBLING.**



**WARNING: ALWAYS FOLLOW THE FIELD STRIPPING INSTRUCTIONS EXACTLY. NEVER DO ANYTHING BEYOND WHAT YOU ARE SPECIFICALLY INSTRUCTED TO DO IN THIS MANUAL. NEVER ALTER OR MODIFY THE PARTS IN YOUR PISTOL.**



**WARNING: WEAR SAFETY GLASSES EVERY TIME YOU ASSEMBLE OR DISASSEMBLE YOUR FIREARM.**

- Replace the bolt into the receiver (FIGURE 40).

**NOTE:** The recoil spring is compressed within the bolt and will fly out with considerable force if not controlled.

- FIGURE 41 identifies the location of the notches in the frame that accept the tabs of the receiver when assembling.

- Replace the barrel and receiver onto the grip frame (FIGURE 42). Push rearward slightly against the spring tension, hook the receiver tabs (FIGURE 40) into the notches in the frame (FIGURE 41) and tip the barrel assembly down at the muzzle so the barrel lug goes into the recess in the frame (FIGURE 43).

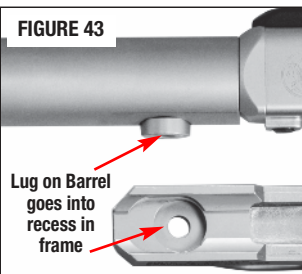
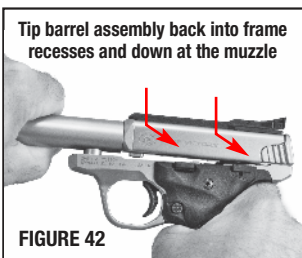
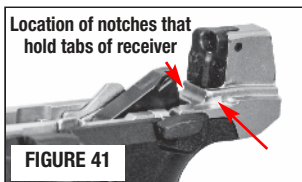
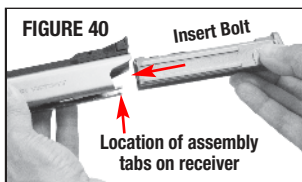

## FIELD STRIPPING / ASSEMBLY CONTINUED

- Replace the takedown screw (FIGURE 44) and tighten it down snug with wrench provided (FIGURE 45).
- Following reassembly, and prior to attempting to load your pistol, always make certain that the pistol is in proper working order and that there are no unusual conditions to prevent its safe operation. Follow all of the inspection procedures outlined in the Inspecting Your Pistol section of this manual.
- Periodically check the tightness of the takedown screw. Tighten as necessary.
- See a video of this procedure at the following address:  
<http://www.smith-wesson.com/firearms/sw22-victory>

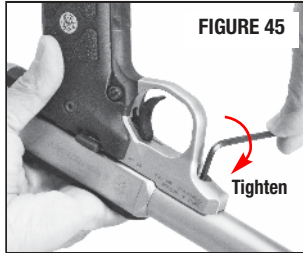
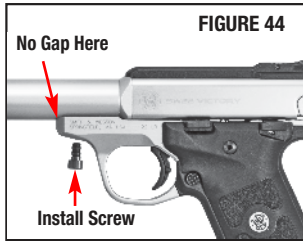

## MAGAZINE



**WARNING: WEAR SAFETY GLASSES EVERY TIME YOU DISASSEMBLE OR ASSEMBLE YOUR MAGAZINE.**



**WARNING: THE MAGAZINE SPRING IS UNDER PRESSURE. CONTROL THE SPRING AND FOLLOWER SO THAT THEY DO NOT FLY OUT AND CAUSE INJURY.**

### MAGAZINE DISASSEMBLY

- Remove magazine from the pistol.
- Remove all cartridges from magazine before disassembly.
- Grasp the magazine and insert a small screwdriver shaft through the slot in the magazine tube and through the spring (FIGURE 46). Compress the spring in the magazine approximately one inch to relieve the tension on the magazine butt plate. With the spring away from the butt plate, slide the butt plate off of the magazine tube as shown.
- Control the spring as you relieve the tension on it and remove the screwdriver (FIGURE 47).

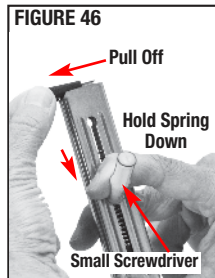

## MAGAZINE CONTINUED

- Remove the spring from the tube. Slide the magazine load assist button down to the hole at the bottom of the magazine tube and pull it out of the follower and tube (FIGURE 48).
- Remove the follower from the tube.
- FIGURE 49 shows magazine fully field stripped.

### MAGAZINE REASSEMBLY

- Insert the follower into the magazine tube, lining up the bottom hole with the key hole (FIGURE 50) and then insert the load assist button into the hole in the follower from the left side.
- Replace the spring and capture it with your finger (FIGURE 51).
- Place the shaft of a small screwdriver into the hole and through the spring and depress it approximately one inch. Slide the butt plate onto the magazine tube and ensure that it is fully seated (FIGURE 52). Gently remove the screwdriver, allowing the spring to extend against the butt plate.
- Check to make sure the butt plate is secure by attempting to remove it partially - keeping in mind that the spring is now under tension and will fly out if the cover is removed quickly.
- See a video of this procedure at the following address: <http://www.smith-wesson.com/firearms/sw22-victory>

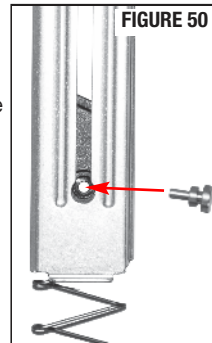
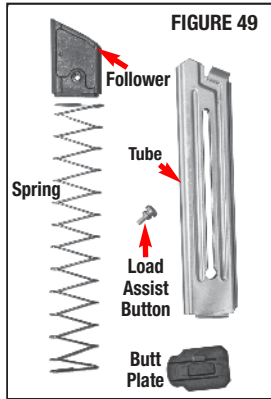
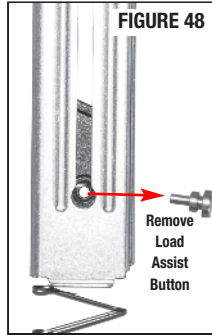

# CLEANING AND MAINTENANCE



**WARNING: ENSURE THAT YOUR FIREARM IS UNLOADED BEFORE BEGINNING TO CLEAN IT. (SEE "INSPECTING YOUR FIREARM" SECTION). ALWAYS FOLLOW THE RULES OF SAFE GUN HANDLING.**



**WARNING: WEAR SAFETY GLASSES EVERY TIME YOU ASSEMBLE OR DISASSEMBLE YOUR FIREARM AND ATTEMPT CLEANING OR MAINTENANCE.**

- Before using your firearm for the first time, it should be cleaned.
- Your firearm was treated at the factory with either a preservative or oil to protect it against corrosion during shipping and storage.
- Preservative and oil should be wiped from the bore, chamber and exposed areas using a clean swab or patch before using the firearm.

**CAUTION:** Never disassemble your firearm beyond the instructions in the Field Stripping / Disassembly section of this manual.

- Purchase cleaning supplies from your firearms dealer that are specifically designated for your type and caliber of firearm. Many suppliers offer these in kit form for your convenience.
- Follow the instructions provided with your cleaning supplies.

**NOTE:** A basic firearm cleaning kit should include: a brass bore brush and a cleaning jag of appropriate size for the bore being cleaned, high-quality gun cleaning solvent and gun oil/lubricant, cotton cleaning patches and a cleaning rod that is long enough to push the brush and jag completely through the barrel.

- Remove excessive firing residue from the bore and chamber using a properly fitted brass brush dipped in gun cleaning solvent. Finish the bore cleaning process by running a dry cotton cloth patch through the bore and chamber to remove residue and solvent.
- Clean the exterior of the firearm using a non-abrasive cleaning cloth.
- After cleaning, lightly coat the metal parts, internal and external with a high quality gun oil.
- Whenever your firearm has been exposed to sand, dust, extreme humidity, water or other adverse conditions, it must be cleaned and lubricated.

---

## CLEANING AND MAINTENANCE CONTINUED

---



**WARNING: ALWAYS HAVE ADEQUATE VENTILATION. CLEANING FIREARMS IN POORLY VENTILATED AREAS, DISCHARGING FIREARMS, OR HANDLING AMMUNITION MAY RESULT IN EXPOSURE TO LEAD AND OTHER SUBSTANCES KNOWN TO CAUSE BIRTH DEFECTS, REPRODUCTIVE HARM, AND OTHER SERIOUS PHYSICAL INJURY. WASH HANDS THOROUGHLY AFTER EXPOSURE.**

**CAUTION:** Always follow the instructions provided with your gun cleaner and gun lubricant.

**CAUTION:** Some cleaners can cause damage to your firearms. You should avoid prolonged solvent immersion and prolonged ultrasonic cleaning of your firearm. Choice of solvent should be restricted to those products specifically developed for firearms maintenance. Damage to a firearm's finish may occur if these cautions are ignored. Ammoniated solvents or other strong alkaline solvents, should not be used on any Smith & Wesson firearm.

- Cleaning is essential to ensure the proper functioning of your firearm.
- Your firearm is a precision instrument. To ensure reliable function it is necessary to follow a routine maintenance procedure. After firing your firearm, be sure to unload it following the procedure outlined in the section entitled "Inspecting Your Pistol" before performing any cleaning or maintenance procedure.
- Remove any gun cleaning solution, oil and fingerprints from the outside surfaces of the firearm. (Finger moisture, if left, could start a corrosion process).



**WARNING: NEVER MANIPULATE, ADJUST OR CHANGE ANY OF THE INTERNAL COMPONENTS OF YOUR FIREARM UNLESS SPECIFICALLY DIRECTED TO DO SO IN THIS MANUAL. IMPROPER MANIPULATION OF ANY INTERNAL COMPONENT MAY AFFECT THE SAFETY AND RELIABILITY OF YOUR FIREARM AND MAY CAUSE SERIOUS INJURY OR DEATH.**



**WARNING: ANY MAINTENANCE OR SERVICE NOT SPECIFIED IN THIS MANUAL MUST BE PERFORMED BY A QUALIFIED GUNSMITH USING GENUINE SMITH & WESSON PARTS. IF YOU DO OTHERWISE, IMPROPER FUNCTIONING OF YOUR FIREARM MAY OCCUR AND SERIOUS INJURY OR DEATH MAY RESULT.**

- If your firearm will be used in a cold climate, be sure to use an oil of an appropriate weight so that it will not congeal in cold temperatures, causing the interaction of important parts to be slowed or halted.



---

## CLEANING AND MAINTENANCE CONTINUED

---

### MAINTENANCE BEFORE STORAGE

- When storing, do not encase your firearm in anything that will attract or hold moisture, for example, leather or heavy cloth. Also, do not store guns with a plug inserted in the barrel for this can be a contributing factor to moisture accumulation. If your firearm is to be stored for an extended period, the bore, chambers and internal working mechanism should be oiled with a high quality lubricating oil or preservative intended for firearms. The external working mechanisms and barrel should be coated with an anti-rust oil. Before using your firearm again, be sure to clean it. Every time you clean your firearm, check it for signs of wear. If wear is noted, do not use the firearm. Return it to Smith & Wesson for service or have it checked by a qualified gunsmith.

---

## LIMITED WARRANTY

**For Owners Within The United States.**

---

This warranty is granted by Smith & Wesson Corp. This warranty is effective from the date of purchase and applies to the original owner of any firearm. With respect to such firearms, this warranty supersedes any and all other warranties.

Smith & Wesson firearms are warranted to be free from defects in material and workmanship. Any such defects of which Smith & Wesson receives written notice within one year from the date of purchase by the original owner, will be remedied by Smith & Wesson without charge within a reasonable time after such notification and delivery of the firearm as provided below.

In the event of an emergency (repairs needed by law enforcement, an upcoming match or hunting trip), call 1-800-331-0852, ext. 4125 and ask for 911 Priority Repair Service. This allows you to speak with a Smith & Wesson representative. Immediately upon receipt, your firearm will be assigned to a gunsmith. After the work is completed, we will return your Smith & Wesson firearm via overnight delivery.

Warranty claims (in writing) and the firearm concerned should be delivered to Smith & Wesson's Customer Service Department, 2100 Roosevelt Avenue, Springfield, Massachusetts 01104. In addition, a copy of the bill of sale in the owner's name, or a copy of BATF Form 4473 indicating date of purchase must be included. It is important that the owner comply with all applicable federal, state and local laws and regulations in the shipment of firearms to Smith & Wesson.

**Note: See the Contact & Shipping section of this manual for further details regarding returns.**

---

## LIMITED WARRANTY CONTINUED

---

Warranty claims should state the model and serial number of the firearm concerned and the description of the difficulty experienced. It is recommended that shipments be insured by the owner, since Smith & Wesson will accept no responsibility for loss or damage in transit. Transportation and insurance charges for return to owner will be paid by Smith & Wesson if the claim is covered by the warranty.

UNDER NO CIRCUMSTANCES SHALL SMITH & WESSON BE RESPONSIBLE FOR INCIDENTAL OR CONSEQUENTIAL DAMAGES WITH RESPECT TO ECONOMIC LOSS, INJURY, DEATH OR PROPERTY DAMAGE, WHETHER AS A RESULT OF BREACH OF THIS WARRANTY, NEGLIGENCE OR OTHERWISE.

Some States do not allow the exclusion or limitation of incidental or consequential damages, so the above limitation or exclusion may not apply to you.

Smith & Wesson will not be responsible for:

- Defects or malfunctions resulting from careless handling, unauthorized adjustments or modifications made or attempted by anyone other than a qualified gunsmith following Smith & Wesson authorized procedures, or failure to follow the disassembly instructions in the Smith & Wesson manual.
- Use of defective or improper ammunition, corrosion, neglect, abuse, ordinary wear and tear, or unreasonable use.
- Criminal misuse, negligence or use under the influence of drugs or alcohol.

Smith & Wesson's Lifetime Service Policy begins after the warranty period has expired. Smith & Wesson will repair, without charge, for the lifetime of the original owner, any Smith & Wesson handgun purchased on or after February 1, 1989, and any M&P series rifle, that is found to have a defect in material or workmanship. Eligibility for this Lifetime Service Policy requires returning the Product Registration Card within 30 days of purchase. The Lifetime Service Policy covers functional defects; it does not include the firearm's finish, grips, magazines or sights. The Lifetime Service Policy is in addition to and not an extension of the Smith & Wesson Warranty.

This warranty gives you specific legal rights. You may also have other rights that vary from state to state.

**NOTE:** All liability is excluded in the event that the instructions in the Smith & Wesson manual are not observed.

# CONTACT AND SHIPPING INFORMATION

For Owners Within The United States

**NOTE:** A Return Merchandise Authorization (**RMA**) is the first step in the process of returning a product in order to receive a repair, replacement or refund. Please contact Smith & Wesson's Customer Service Dept. (via e-mail: [qa@smith-wesson.com](mailto:qa@smith-wesson.com) or by phone at 800-331-0852 ext. 4125) to obtain authorization to return your firearm so we can process it quickly and efficiently. The RMA number that is supplied by Smith & Wesson must be displayed on the outside of the returned product's packaging; returns without an RMA number will be routed differently which will result in delayed processing.

The issuance of an Return Merchandise Authorization (**RMA**) allows Smith & Wesson an opportunity to try to diagnose and correct a customer's concerns with the product (such as ammunition problems) before it is returned. Accordingly, please contact us before returning your Smith & Wesson firearm.

## STEP 1: CONTACT CUSTOMER SERVICE

Tel: 800-331-0852 • 413-781-8300 ext. 4125  
E-mail: [qa@smith-wesson.com](mailto:qa@smith-wesson.com)

## STEP 2: RETURNS - FOR SERVICE

**SEND ALL FIREARMS TO:**  
Smith & Wesson  
2100 Roosevelt Avenue • Springfield, MA 01104

Should your Smith & Wesson firearm require service, it should be returned to the Smith & Wesson factory.

- Call or e-mail the Customer Service Dept. for authorization and shipping instructions.
- Ensure that the firearm is unloaded.
- **Do not attempt to ship a firearm via US Postal Service; only federally licensed dealers may ship a firearm by US Postal Service.**
- **DO NOT SHIP ANY AMMUNITION.**

---

## CONTACT AND SHIPPING INFORMATION CONTINUED

---

- Enclose a letter which includes your full name and address (no P.O. Boxes, please), daytime telephone number, e-mail address, the serial number of the firearm, and details of the problem experienced (stating the brand and type of ammunition used when the problem occurred) or work desired.
- Record the serial number before shipping, in case you wish to check on the repair status of your firearm.
- Please remove all custom parts and accessories, such as stocks, special sights and scopes, or slings from your firearm before returning.
- Place the firearm in its original case or in a similarly secure container and pack it securely.
- The package must **NOT** bear any markings which indicate the identity of the contents.
- It is most important that you comply with federal, state, and local laws and regulations. The following guidelines are meant to help, but you must seek assistance from the appropriate authorities if necessary.
- If your firearm must be replaced, it may be necessary to ship the replacement to a dealer rather than directly to you. You will be requested to furnish a signed FFL (Federal Firearms License) from your dealer in such an instance.
- Warranty repair work will begin upon receipt and examination of the firearm. In the case of repairs or work not covered by the warranty, a quotation covering the cost of the work plus round trip transportation charges will be sent to you. Repairs or modification will be scheduled upon receipt of payment.
- A parts list can be obtained by contacting Smith & Wesson Customer Service.

 **WARNING: YOU MAY PURCHASE ACCESSORIES FOR YOUR SMITH & WESSON FIREARM. YOU MUST HAVE SOME OF THESE PARTS INSTALLED BY A GUNSMITH QUALIFIED TO PERFORM SERVICE ON SMITH & WESSON FIREARMS. YOU MUST NEVER ATTEMPT TO MODIFY YOUR FIREARM OR INSTALL REPLACEMENT PARTS IN YOUR FIREARM. ALWAYS USE A QUALIFIED SMITH & WESSON GUNSMITH EVEN IF THE REPAIR SEEMS TO BE SIMPLE.**

---

## CUSTOM SERVICE

---

We understand that Smith & Wesson gun owners may want to enhance their guns with custom gunsmithing, refinishing or accessories. Our gunsmiths offer specialized services and exclusive products to enhance your shooting experience.

Accessories for your Smith & Wesson firearm are available from your local Smith & Wesson Stocking Dealer, or directly from Smith & Wesson.

Contact the Customer Service Department at 1-800-331-0852, ext. 4125 for information about these services.

When ordering directly from the factory, please provide the following information:

- Model Number
- Dash Number
- Serial Number
- Approximate date of purchase
- Complete Return Address
- VISA/Discover/MasterCard Number and Expiration Date
- For Foreign Orders Only, Fax Number or E-mail Address

---

## PATENT INFORMATION

---

This product may be covered by one or more patents. Visit [www.smith-wesson.com](http://www.smith-wesson.com) for virtual patent information.

---

## INTERNATIONAL WARRANTY CENTERS

For Owners Outside The United States

---

**NOTE:** Addresses and contact information for International Warranty Centers is available on the Smith & Wesson website at [www.smith-wesson.com](http://www.smith-wesson.com) or by calling Customer Service toll-free at 1-800-331-0852 ext 4125.

# PERFORMANCE CENTER® TRIGGER ADJUSTMENT

On Those SW22 Victory® Models So-equipped

**WARNING: ENSURE THAT YOUR FIREARM IS UNLOADED BEFORE BEGINNING ANY DISASSEMBLY, ADJUSTMENT OR CLEANING. ALWAYS FOLLOW THE RULES OF SAFE GUN HANDLING. KEEP THE MUZZLE POINTED IN A SAFE DIRECTION AT ALL TIMES.**

**WARNING: WEAR SAFETY GLASSES EVERY TIME YOU DISASSEMBLE OR ASSEMBLE YOUR FIREARM, ADJUST ANY COMPONENT OF THAT FIREARM OR ATTEMPT TO CLEAN IT.**

## TRIGGER ADJUSTMENT SCREWS - On those models so-equipped

- Several SW22 Victory® Performance Center® model pistols have two (2) trigger adjustment set screws (FIGURE A1). These enable the shooter to fine tune the factory-set trigger for both takeup/pretravel and overtravel.
- Read and understand this entire manual before attempting any adjustments.
- A 1/16" hex wrench is provided with the SW22 Victory® Performance Center® pistol from the factory for making trigger adjustments.

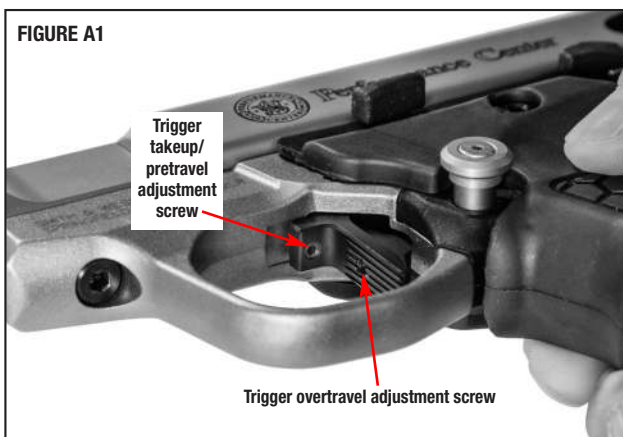

## TRIGGER ADJUSTMENT CONTINUED

### SW22 Victory® Performance Center® Trigger Takeup/Pretravel Adjustment

- The trigger takeup/pretravel adjustment screw - this set screw is used to minimize the amount of trigger travel prior to the pistol firing when the trigger is pulled.
- Insert an EMPTY magazine into the pistol until it is locked in position and then pull the bolt rearward to cock the hammer. Release the bolt to its closed position by depressing the bolt stop and letting the bolt move fully forward. Place the manual safety lever down in the “FIRE” position.

**NOTE:** The S&W® SW22 Victory® pistol is equipped with a magazine safety that prevents the pistol from firing with the magazine removed. In order to test the trigger pull, the EMPTY magazine must be in place in the pistol.

- (See FIGURE A2) With the internal hammer cocked (by cycling the bolt fully back and then closed on an empty chamber), adjust the takeup/pretravel set screw (clockwise as viewed from the bottom of the pistol) until the trigger “breaks” causing the internal hammer to fall with an audible “click”.
- Cycle the bolt fully again to cock the internal hammer. Adjust the takeup/pretravel set screw out (turning it counterclockwise as viewed from the bottom), until an audible “click” is heard (approximately  $\frac{3}{4}$  turn), indicating minimum trigger reset has been achieved. Continue to turn the set screw out approximately  $\frac{1}{4}$ -  $\frac{1}{2}$  turn (counterclockwise as viewed from the bottom of the pistol) after audible “click” to provide reliable function of the trigger reset.



**NOTE:** Sufficient trigger return travel is required to properly reset the trigger for the next shot.

## TRIGGER ADJUSTMENT CONTINUED

### SW22 Victory® Performance Center® Trigger Overtravel Adjustment



- (FIGURE A3) This set screw is used to minimize the amount of trigger movement rearward after the pistol fires.

- Use the 1/16" hex wrench to adjust the rearward protrusion of the overtravel set screw out the back of the trigger

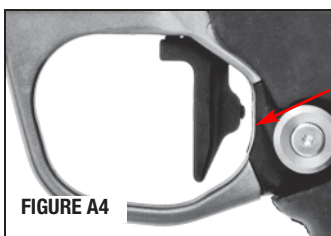

(FIGURE A4) by turning it clockwise (as viewed from the front of the pistol), or to a position where the trigger will not "break" and release the hammer to "fire" the pistol when the trigger is pulled.

- Adjust the overtravel set screw (counter-clockwise as viewed from the front of the pistol) until pulling the trigger will "fire" the pistol and you hear a "click" as the hammer falls. Further adjust the overtravel set screw (counter-clockwise as viewed from the front) at least 1/4 turn further to help ensure reliable trigger function.

#### Trigger Inspection After Adjustment:

- After ensuring that the pistol is unloaded and the chamber is empty, proceed to dry-fire the pistol several times to ensure proper trigger operation.
- Environmental conditions (i.e. excessive fouling), over-adjustment, and multiple loosening of the set screws may cause a fail-to-fire condition. This will necessitate repositioning of the set screw(s) until reliable operation is restored. A small amount of thread-locking sealant such as LOCTITE® blue is recommended on the threads of the set screws to secure them in position once optimal trigger pull is achieved.

**NOTE:** It is nearly impossible to position the set screws to eliminate 100% of takeup/pretravel or the overtravel trigger movement and still ensure reliable function of the trigger. Adjustments can be made to achieve a very good trigger pull that suits the shooter's needs.



# BATTERY WARNINGS



**WARNING: IF A BATTERY OPERATED ACCESSORY OR ATTACHMENT (I.E. LASER, OPTICAL SIGHT OR FLASH-LIGHT, ETC.) IS SUPPLIED OR USED WITH THIS FIREARM, THE FOLLOWING WARNINGS AND INSTRUCTIONS MUST BE ADHERED TO.**



**WARNING: KEEP BATTERIES AWAY FROM CHILDREN. THERE IS A CHEMICAL BURN HAZARD ASSOCIATED WITH BATTERIES.**



**WARNING: IF A NEW OR USED LITHIUM BUTTON/COIN CELL BATTERY IS SWALLOWED OR ENTERS THE BODY, IT CAN CAUSE SEVERE INTERNAL BURNS AND CAN LEAD TO DEATH IN AS LITTLE AS 2 HOURS. ALWAYS COMPLETELY SECURE THE BATTERY COMPARTMENT. IF THE BATTERY COMPARTMENT DOES NOT CLOSE SECURELY, STOP USING THE PRODUCT, REMOVE THE BATTERIES, AND KEEP IT AWAY FROM CHILDREN. IF YOU THINK BATTERIES MIGHT HAVE BEEN SWALLOWED OR PLACED INSIDE ANY PART OF THE BODY, SEEK IMMEDIATE MEDICAL ATTENTION.**

- When used correctly, batteries provide a safe and dependable source of portable power. However, misuse or abuse may result in leakage, fire, or explosion.
- Batteries can explode or leak and cause burns if installed backwards, disassembled, charged, or exposed to water, fire or high temperature.
- Always take care to install your batteries correctly observing the “+” and “-” marks on the battery and the device.
- Always replace the whole set of batteries at one time, taking care not to mix old and new batteries, or batteries of different types.
- Store unused batteries in their original packaging and away from metal objects that may short-circuit them.
- Remove discharged batteries from equipment promptly to avoid possible damage from leakage.
- Never dispose of batteries in fire. (Failure to observe this precaution may result in an explosion.)
- The batteries are supplied in a charged state and are not designed for recharging. Recharging may cause leakage, fire, or explosion.
- The batteries should be disposed of properly, including keeping them away from children.
- Dispose of used batteries immediately. Even used batteries can cause injury.

# MUZZLE COMPENSATOR

On Those S&W® Pistols So-Equipped

**WARNING:** ALWAYS KEEP YOUR FACE, HANDS, FINGERS, OR ANY OTHER BODY PARTS AWAY FROM THE BARREL PORTS (INCLUDING PORTS IN COMPENSATORS) DURING FIRING. ALWAYS ENSURE THAT BYSTANDERS ARE AWAY FROM THE BARREL PORTS DURING FIRING. PARTICLES AND HOT GAS WILL BE FORCED OUT OF THE BARREL PORTS DURING NORMAL USE. FAILURE TO FOLLOW THIS WARNING WILL CAUSE SERIOUS PERSONAL INJURY AND MAY ALSO RESULT IN DAMAGE TO PROPERTY (HOLSTERS, CLOTHING, ETC.).

- DO NOT SHOOT A PISTOL WITH A PORTED BARREL "FROM THE HIP" OR FROM A RETENTION POSITION (WHEN THE FIREARM IS IN CLOSE PROXIMITY TO ANY PART OF THE BODY).
- USE CAUTION WHEN SHOOTING TO AVOID CONTACT WITH ANY SURROUNDING OBJECTS THAT COULD BE DAMAGED BY THE PARTICLES AND HOT GAS FORCED FROM THE BARREL COMPENSATOR PORTS DURING FIRING.

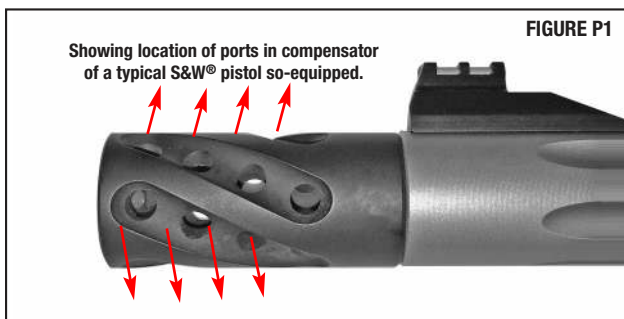

**SW22 Victory® Performance Center® - Cleaning the Compensator - if so-equipped**

**NOTE:** Use of some types of 22LR rimfire ammunition may result in lead and carbon buildup in the compensator more quickly than other brands. Regular inspection and cleaning of the bore of the compensator is essential - regardless of the type of ammunition used.

**WARNING:** THE BORE CHANNEL OF THE COMPENSATOR MUST BE KEPT FREE OF LEAD AND CARBON BUILDUP THAT CAN OCCUR THROUGH FIRING. FAILURE TO KEEP THE COMPENSATOR'S BORE CHANNEL CLEAR COULD RESULT IN A BULLET STRIKE THAT MAY DAMAGE THE FIREARM AND CAUSE PERSONAL INJURY.

---

## MUZZLE COMPENSATOR CONTINUED

---

- Ensure that the pistol is unloaded (magazine removed) and that no cartridge is in the chamber prior to addressing the compensator.
- Remove the compensator by unscrewing it by hand from the pistol barrel. DO NOT attempt to clean or disassemble the compensator while it is installed on a loaded firearm.
- While taking precautions to avoid exposure to lead (e.g. gloves and face dust mask) use suitable cleaning tools (e.g. non-marring brush, toothpick, wooden dowel, cotton patch, etc.) and non-corrosive solvent like CLP (Cleaner, Lubricant, Preservative) to clean the interior (bore) and surfaces of the compensator.

**CAUTION:** The compensator is made of an alloy that is not suitable for use in ultrasonic cleaners.

- When cleaning, DO NOT use sharp metal tools or objects to clean or scrape the compensator.
- The o-ring at the base of the threads can be left in place when the compensator is removed for cleaning.
- Tighten the compensator onto the muzzle threads by hand until snug.

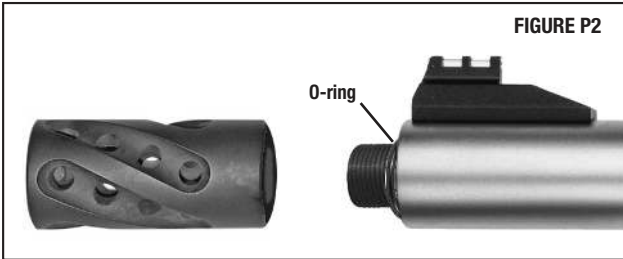

This handgun is not equipped with a device that fully blocks use by unauthorized users. More than 200,000 firearms like this one are stolen from their owners every year in the United States. In addition, there are more than a thousand suicides each year by younger children and teenagers who get access to firearms. Hundreds more die from accidental discharge. It is likely that many more children sustain serious wounds or inflict such wounds accidentally on others. In order to limit the chance of such misuse, it is imperative that you keep this weapon locked in a secure place and take other steps necessary to limit the possibility of theft or accident. Failure to take reasonable preventative steps may result in innocent lives being lost, and in some circumstances may result in your liability for these deaths.

The certification below is required only for handguns sold in the United States with a barrel length shorter than 3". Smith & Wesson Corp. hereby certifies average accuracy test results for all new handguns with a barrel shorter than 3" as follows:

7 yards	14 yards	21 yards
1.7"	3.9"	6.3"

This certification is based on tests conducted by Smith & Wesson Corp. using a fixed handgun rest and firing ammunition manufactured by a member of the Shooting Arms and Ammunition Manufacturers Institute (SAAMI) as defined in ANSI/SAAMI Z299.3-1993.

This certification represents actual tests based on several handguns, selected at random. Your particular handgun may have accuracy better than the results stated in this certification.



3010478

Smith & Wesson  
2100 Roosevelt Avenue • Springfield, MA 01104  
[www.smith-wesson.com](http://www.smith-wesson.com)

P/N 3010478

REV:SW22\_VICTORY\_080118